

PLAN A - EXISTING SITE CONDITIONS
AS INTERPRETED FROM GOOGLE MAPS
(PRIOR TO CONSTRUCTION OF EXISTING SITE COMPOUND)
SCALE - 1:1000

NOTES
AREA OF EXISTING SITE -
• 1.12Ha (OVERALL)
• 0.58Ha (GRASSED AREA)
• 0.54Ha (ROUGH AREA)

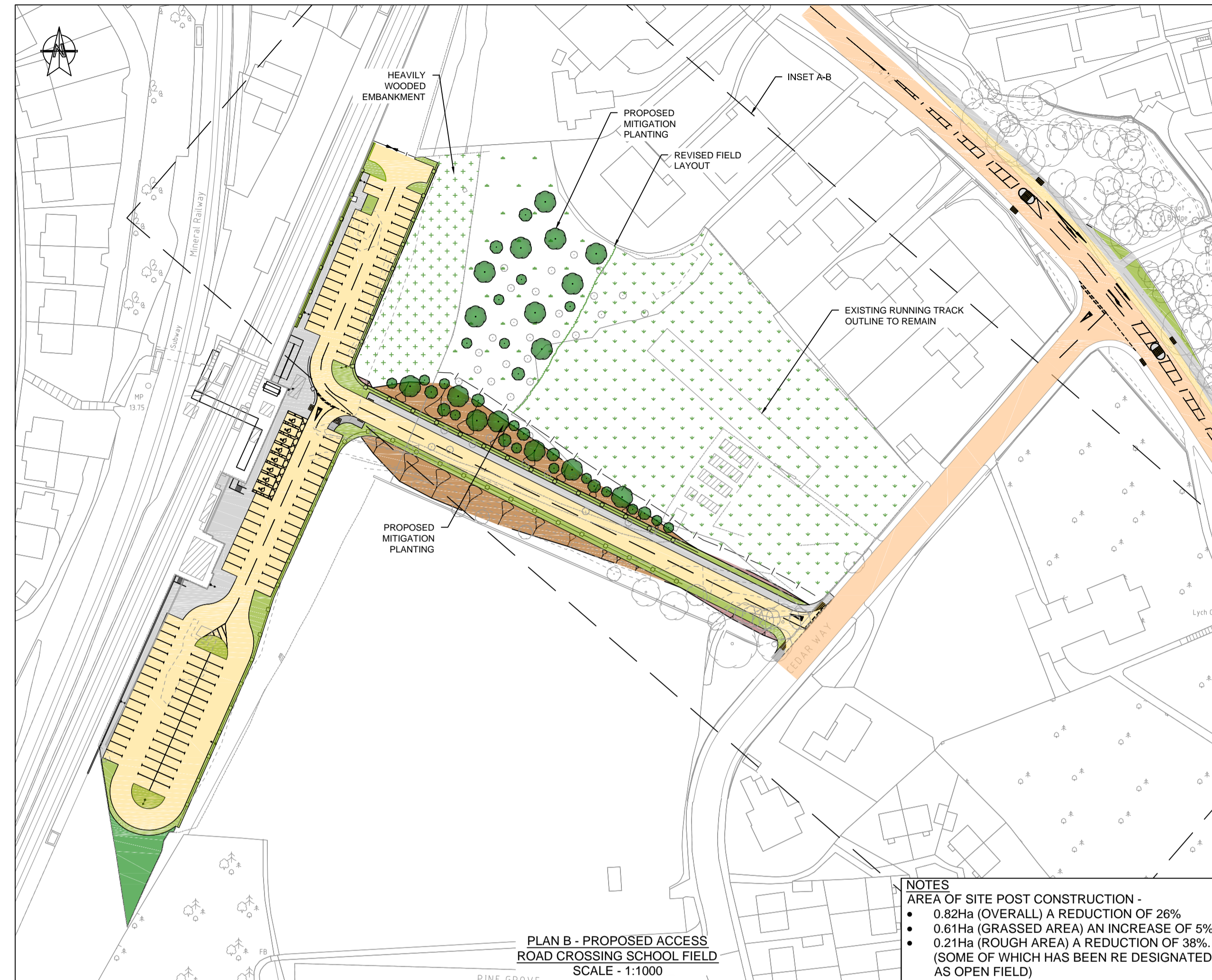

PLAN B - PROPOSED ACCESS ROAD CROSSING SCHOOL FIELD
SCALE - 1:1000

NOTES
AREA OF SITE POST CONSTRUCTION -
• 0.82Ha (OVERALL) A REDUCTION OF 26%
• 0.61Ha (GRASSED AREA) AN INCREASE OF 5%
• 0.21Ha (ROUGH AREA) A REDUCTION OF 38%
(SOME OF WHICH HAS BEEN RE DESIGNATED AS OPEN FIELD)

- NOTES**
- THIS IS A C.A.D. DRAWING AND SHOULD NOT BE AMENDED BY HAND.
 - ALL DIMENSIONS IN METRES UNLESS OTHERWISE STATED.
- KEY**
- CARRIAGEWAY / CAR PARK
 - EXISTING CARRIAGEWAY TO BE RESURFACED
 - PAVED AREA
 - FOOTWAY
 - BATTER SLOPE CUT
 - BATTER SLOPE FILL
 - LANDSCAPE
 - VERGE
 - WATER
 - LIGHTING COLUMN (INDICATIVE LOCATIONS ONLY)
 - FENCING
 - VEHICLE RESTRAINT SYSTEM (VRS)
 - ACCESS GATE TO NETWORK RAIL LAND
 - PROPOSED TRAFFIC SIGN



INSET A - UNDER 11/12 RUGBY PITCH
(AS SPECIFIED BY WRU)
SCALE - 1:1000



INSET B - PROPOSED U11 FOOTBALL PITCH
(AS SPECIFIED BY THE FAW)
SCALE - 1:1000

© Crown Copyright and database right 2012. Ordnance Survey 100021874. Welsh Government.
© Hafwraint a hawliau cronfa ddata'y Goron 2012. Rhif Twydded yr Arrolwg Ordnans 100021874.
Digital Mapping Solutions from Dotted Eyes Limited © Copyright and Database right 2011

Rev	Date	Description	By	Chk	App
A	29/04/15	PROPOSED AMENDED	AM	GS	GS

FOR DISCUSSION

29 Cathedral Road
Cardiff
CF11 9HA

Tel: 44-(0)29-2082-7000
Fax: 44-(0)29-2082-7001

Client:
WELSH GOVERNMENT

Site/Project:
METRO STATION IMPROVEMENT PROGRAMME PHASE 1

Title:
YSTRAD MYNACH STATION ACCESS RAMP IMPACTS

Drawn: AM	Checked: GS
Designed: AM	Approved: GS
Date: 25/03/2015	Scale: AS SHOWN A1 Sheet: 1 OF 1
Project Number: 35136900-HHC	Drawing Number: SK009
	Revision: A

© Copyright Parsons Brinckerhoff